

WEAVERTHORPE PARISH COUNCIL
c/o Boltby Cottage
Main Road, Weaverthorpe
Malton North Yorkshire
YO17 8EY



15th December 2017

Jill Thompson,
Specialist (Place) Team,
Ryedale District Council,
Ryedale House,
Old Malton Road,
Malton,
North Yorkshire,
YO17 7HH

Dear Ms Thompson

Local Plan Sites Document and Policies Map consultation

Further to your request for comments on the above consultation, please find our comments below.

The only change we would request to the Policies Map for Weaverthorpe, is that two pieces of land be included as Visually Important Undeveloped Areas. These pieces of land are:

Weaverthorpe War Memorial Site grid ref: SE 96419 70839

Land to the south of Wesley Cottage which is publicly maintained recreational land, grid ref: SE 96790 70888

The locations are marked on a copy of the enclosed map along with individual prints of the OS maps of the above two areas.

For your information at the last meeting of Weaverthorpe Parish Council, the Council agreed to register, these pieces of land, along with other land already included in your VIUA designation, as Common Land.

Yours sincerely



J/House
Clerk to Weaverthorpe Parish Council

SE 965 709

SE 963 709

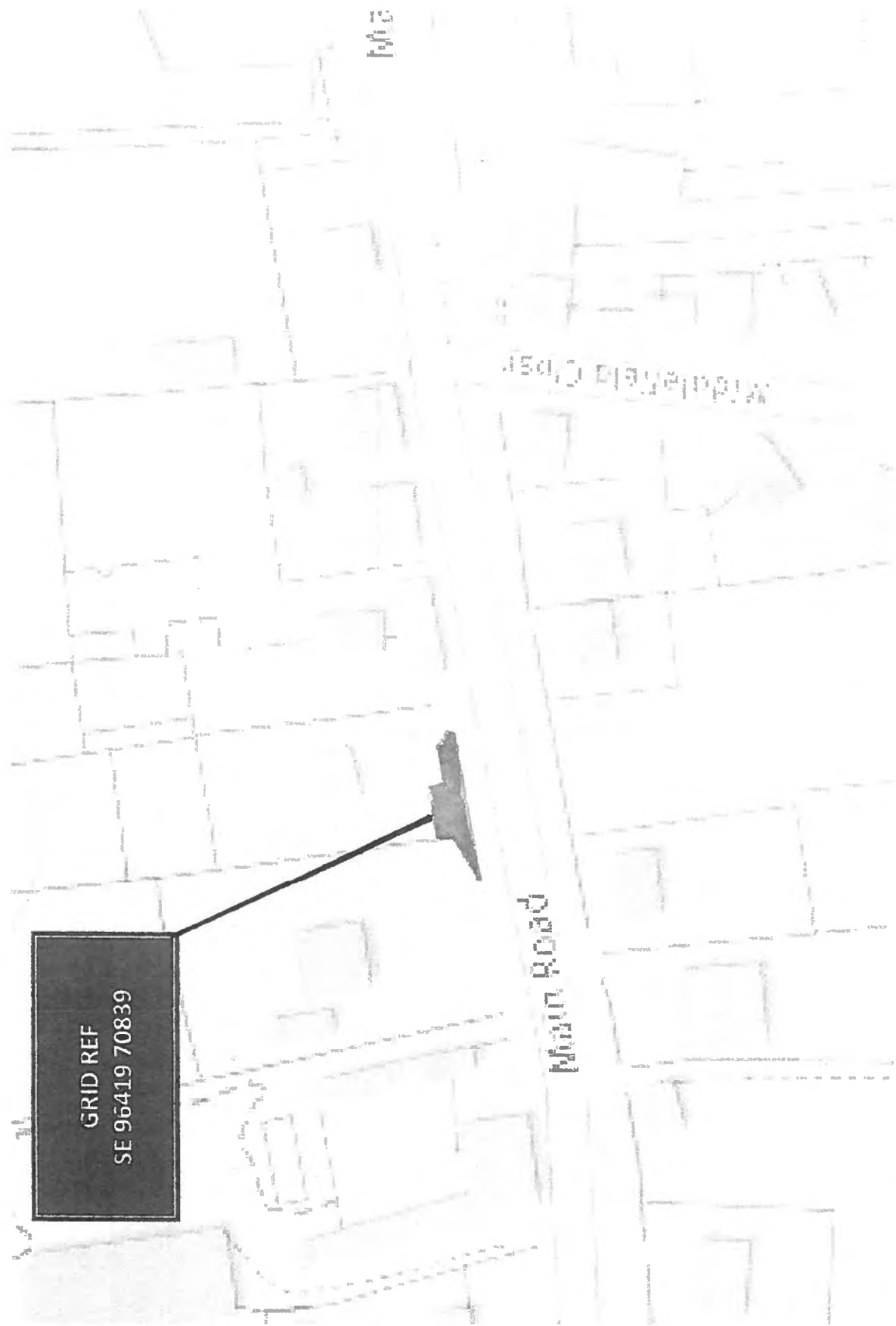

100

100

Main Road

GRID REF
SE 96419 70839



SE 963 707

SE 965 707

SE 963 709

SE 966 700

GRID REF
SE 96790 70888

Back Lane

PWW

Main Road

Main Road

Rarey

© Crown copyright and database rights 2017 Ordnance Survey 100047444
For full terms and conditions please visit www.ordnancesurvey.co.uk



SE 966 700

SE 969 703

GRID REF
SE96419 70839

GRID REF
SE96790 70888

