



The Green
16 Church Street
Kirkbymoorside
YORK
YO62 6AZ

RYEDALE DM

- 2 JAN 2018

DEVELOPMENT
MANAGEMENT

Mr Gary Housden
Head of Planning
Ryedale District Council
Ryedale House
Old Malton
North Yorkshire
YO17 7HH

22nd December 2017

Dear Mr Housden

Publication of Ryedale Plan
Local Plan Sites Document & Policies Map
Your e mail dated 02 November 2017
Kirkbymoorside Sites 209 & 556

I wrote a letter to your Ms Thompson, Principal Specialist (Place) on the 10th November 2017, copy attached. I am still awaiting a response to that correspondence and also action to be taken.

It also seems unreasonable and unnecessary to designate part of my private garden as valued landscape, when because of heavy vegetation screening (this could only be valued by me.

I look forward to hearing from you.

Yours sincerely

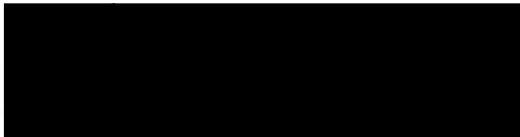

C I Watson

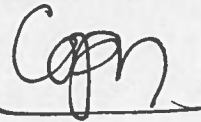
The Green
16 Church Street
Kirkbymoorside
YORK
YO62 6AZ

Ms Jill Thompson
Principal Specialist (Place)
Ryedale District Council
Ryedale House
Old Malton
North Yorkshire
YO17 7HH

10th November 2017

Dear Ms Thompson

Publication of Ryedale Plan
Local Plan Sites Document & Policies Map
Your e mail dated 09 November 2017
Kirkbymoorside Sites 209 & 556

I refer to your e mail received today in respect of the above.

Upon reviewing the document and associated plan I was disappointed to see that my site has been deleted and the comment in your Supporting Document - Background Paper stating that "*This site has been discontinued by the landowner*".

There has been two representations made in respect of the above land, these were given the site Reference No 209 (0.14ha), this was made by Cundalls on behalf of the then landowner. A subsequent representation was then made in respect of a larger composite site by the then owner Mr JHK Clark, following his acquisition of additional adjacent land, your Reference No 556 (0.26ha).

After I had purchased the subject property in February 2015 from Mr Clark, I submitted a letter to your Council dated 9th March 2015 (copy enclosed) after having seen the two representations appearing on your sites schedule. The purpose of this letter was to confirm that I was the new owner of the property and to suggest that the older site representation Reference No 209, be deleted in favour of the Site Reference 556 (the composite site) and reflecting the up to date ownership. I did not want the site deleting from your schedule of sites

I attach a plan showing the composite ownership in red, access for which is made from the corner of Howe End adjacent to No 21 Howe End.

I should be pleased if you would kindly reinstate the site as a potential development site (for 1No property), in your schedule of sites. I am keen to see this site allocated within your plan and will in due course develop it out.

Please do not hesitate to contact me if you need further clarification.

Yours sincerely

C I Watson

CPK



The Green
16 Church Street
Kirkbymoorside
North Yorkshire
YO62 6AZ

Ms Charlotte Bogg
Ryedale District Council
Ryedale House
Old Malton
North Yorkshire YO17 7HH

9th March 2015

Dear Ms Bogg

Potential Development Sites, Kirkbymoorside

Site No 209 (0.14ha) : Site No 556 (0.26ha)

I am the owner of the above property having acquired it in early February 2015 from the previous owner Mr JHK Clark

I note from your website that two representations have been made in respect of this property as a potential development site:-

- i) **Site No 209 (0.14ha)** – This appears to have been made by Cundalls on behalf of an owner for only part of the full site, which was owned by an adjacent neighbour prior to Mr Clark acquiring it to create a composite site (this adjacent neighbour has since sold his interest in the adjacent property).
- ii) **Site No 556 (0.26ha)** – This representation was made to you by the previous owner of my property, Mr JHK Clark, for the composite site.

May I suggest that it would be sensible for you to delete Site No 209 from your list of potential development sites as it no longer defines the extent of the new composite site.

As the owner of the property I would like to endorse the representation for Site No 556 (0.26ha) made by Mr JHK Clark for the new composite site.

Yours sincerely

Charles I Watson

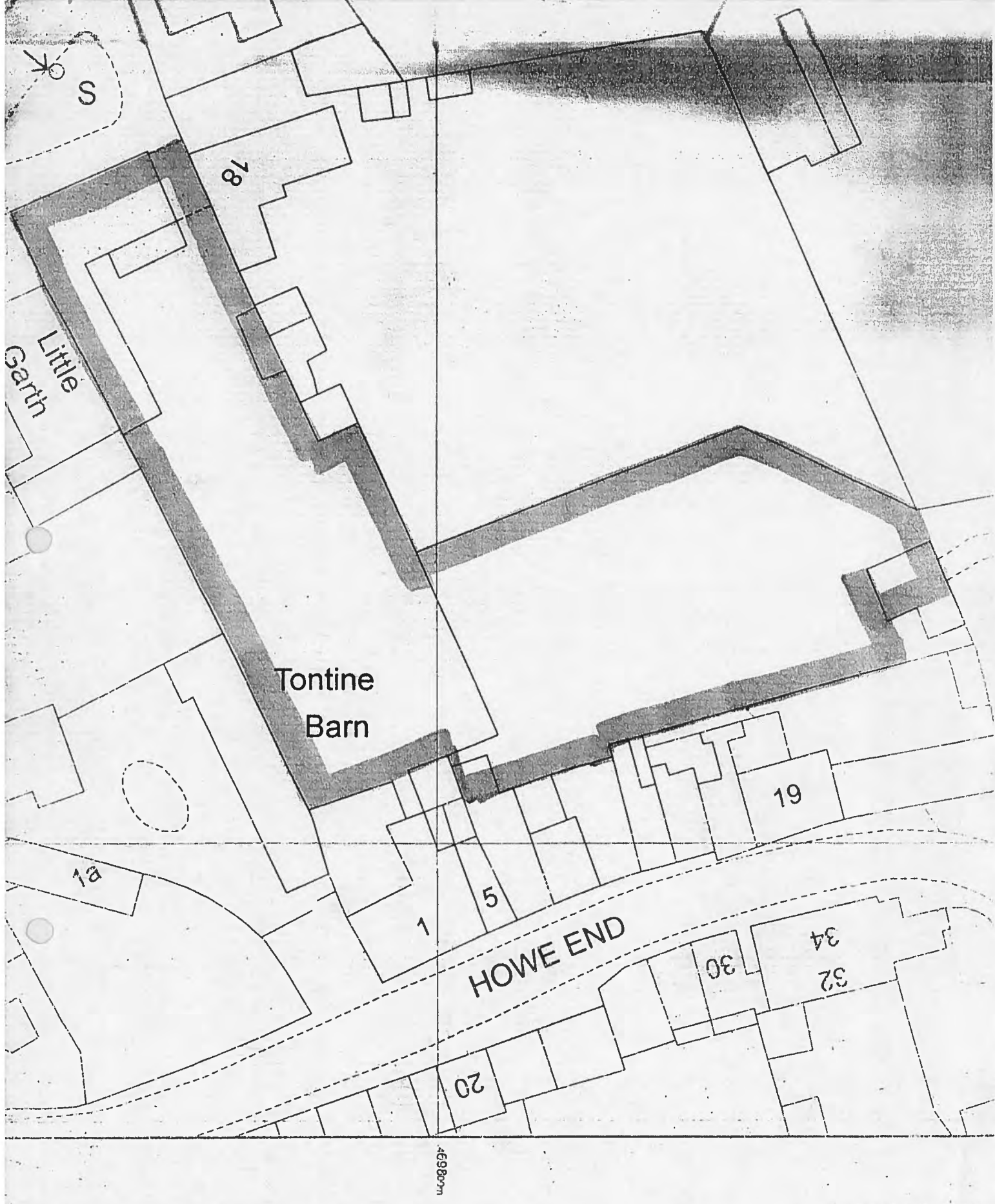

© 2009 from the Ordnance Survey National Database and incorporating surveyed revision data. © Crown Copyright 2009.

Reproduction in whole or part is prohibited without the permission of Ordnance Survey.

The OS Symbol and OS Sitemap are registered trademarks of Ordnance Survey, the national mapping agency for Great Britain.

The presence of a road, track or path is not a guarantee of its existence.

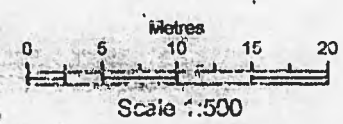

Supplied by Latitude - Southampton