

Rachel Balmer  
 Forward Planning Officer  
 Ryedale District Council  
 Ryedale House  
 Malton, YO17 7HH.

Dorlin House  
 Cornborough Road  
 Sheriff Hutton  
 York  
 13/6/16  
 01347-878482  
 Mob:0797-274-3100(txt is best)

Dear Rachel,

Re: Paddock 8358 - 2270 sq. mtrs. (0.561 acre)  
**APPLICATION FOR ACCEPTANCE  
 AS DEVELOPMENT LAND.**

---

Thank you for the recent phone conversation regarding this Paddock of 2270 sq. mtr. which I have recently had surveyed by Ryedale Land Surveys (Graham Goforth) and enclose a copy of that Plan.

My son Graeme wished to build a "Starter Home" on part of this paddock so I spoke to Mr Hunter and applied for **Pre-application Advice**. My son then met Ryedale Staff on site as I had to be in Hospital with my wife. We received a letter dated 12/11/15 ref:15/01040/PREAPP regarding this land from Mr. Hunter, which was encouraging.

A local builder **Alcuin Homes** had shown an interest in some of Dorlin House land and has, I understand, applied through their Agent PBPlanning for acceptance of 1.04 Ha. of this land.

This plot has houses on 3 sides, the 4th side being bounded by Cornborough Road and there is an existing access gate adjacent to the entrance to "Hill View". The Dorlin House entrance currently also services the Stables & Workshop at the rear, this entrance needs improvement for Car & Trailers.

My son no longer requires a house as he has bought a Narrowboat and has a living-mooring, but as my wife has recently died I now need a new home as Dorlin House & land is far too big for my needs as it is a family home.

Yours faithfully,

Mr. J. W. Shaw.

Enc: Recent Plan of Dorlin House land.  
 4-house possible layout.

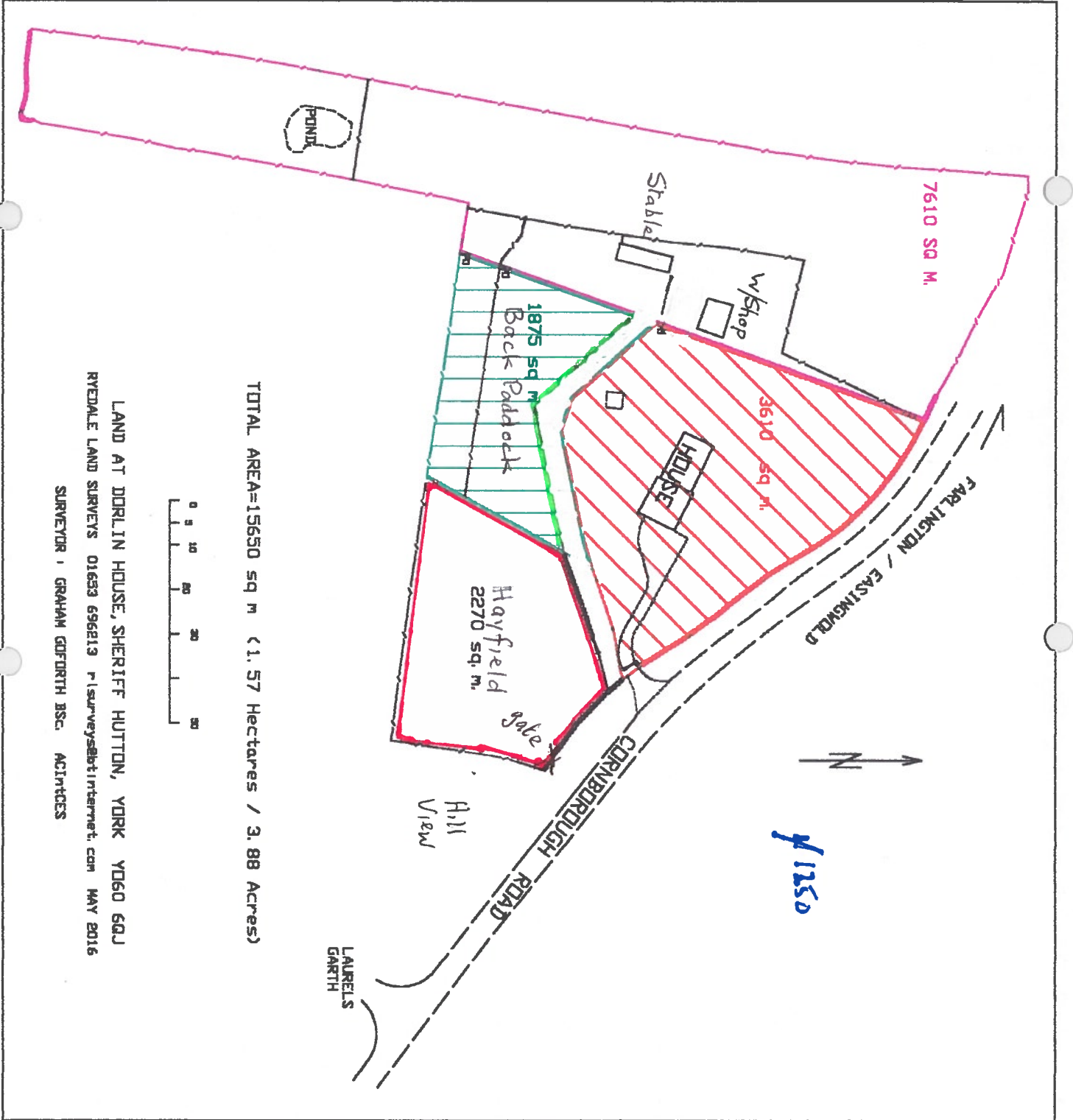

TOTAL AREA=15650 sq m (1.57 Hectares / 3.88 Acres)



LAND AT DORRIN HOUSE, SHERIFF HUTTON, YORK YO60 6QJ  
 RYDALE LAND SURVEYS 01653 696213 r.landsurveys@btinternet.com MAY 2016

SURVEYOR : GRAHAM GODFORTH BSC. ACINTECS

Continued as Submission  
 plan 22.06.2016

JWS

LAND AT DORLIN HOUSE  
SHERIFF HUTTON



4 HOUSE  
POSSIBLE  
LAYOUT